

2

V

1

FLAT .01 DEEP X .50 LONG TYP BOTH ENDS

NO. 6-32 UNC-2A THRD.  
2X TERMINALS WITH NUTS

2X  $\varnothing 0.4995^{+0.0000}_{-0.0005}$

TACH LEADS NO. 22 AWG 24 L

B

B

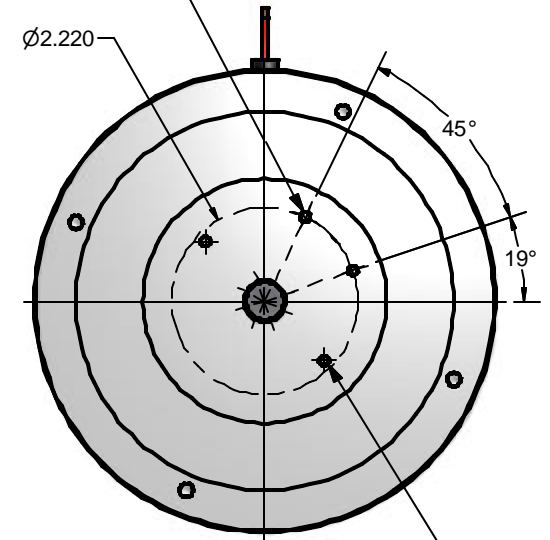
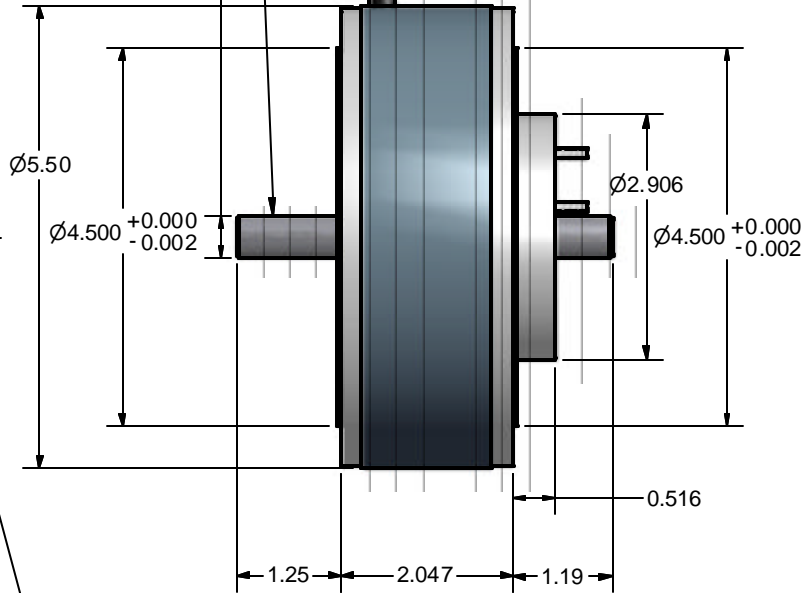
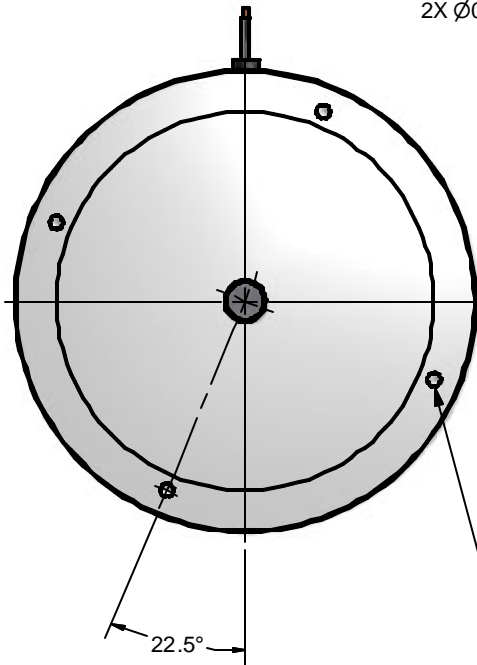

NO.10-32 UNC-2B X.21 DEEP  
4 HOLES EQUALLY SPCACED ON  
A  $\varnothing 4.875$  B.C.

NO. 4-40 SCREW  
TYP 2 PLS.-REF

V

V

A

A

PERFORMANCE SPECS	UNITS
Peak Torque	1285 oz-in
Rated Speed	3000 RPM
Rated Continuous Torque @ 25 C	130 oz-in
Rated Power Output	275 Watts
Continuous Stall Torque	116 oz-in
Cogging Torque	0.0 oz-in
Rated Terminal Voltage	43.3 Volts
Rated Continuous Current	8.65 Amps
Peak Current	84 Amps
Continuous Stall Current	7.9 Amps
Back EMF Constant +/- 10%	12.1 V/kRPM
Moment of Inertia	.019 oz-in-sec <sup>2</sup>
Torque Constant +/- 10%	16.4 oz-in/Amp

DRAWN  
Sal 2/9/2007

MFG

APPROVED

UNLESS OTHERWISE SPECIFIED:  
 DIMENSIONS ARE IN INCHES  
 TOLERANCES  
 ANGLES ±1°-30'  
 3 PLACED C ±.005  
 2 PLACED C ±.010  
 SURFACE ROUGHNESS ON  $\sqrt{}$   
 MACHINED SURFACES  
 REMOVE ALL BURRS, BREAK SHARP  
 EDGES TO .015 IN MAX.  
 DIM LIMITS ARE HLD. AFTER PLATING  
 MACHINED DIAS. ON A COMMON  
 CENTER  
 LINE CONCENTRIC WITHIN .005 T.I.R.  
 UNMACHINED DIAS. CONCENTRIC  
 WITHIN .031 T.I.R.  
 SQUARENESS AND PARALLELISM OF  
 MACHINED SURFACES .002 PER INCH  
 TO A MAX. OF .002 FOR A SINGLE  
 SURFACE.

TITLE 12CD/CDT		
PART NO 12CD/CDT	JOB NO	REV
SCALE	SHEET 1 OF 1	

2

V

1