

.375-16 UNC-2B X .61 DP TAP
4 HOLES EQUALLY SPACED ON 5.875 DIA BC

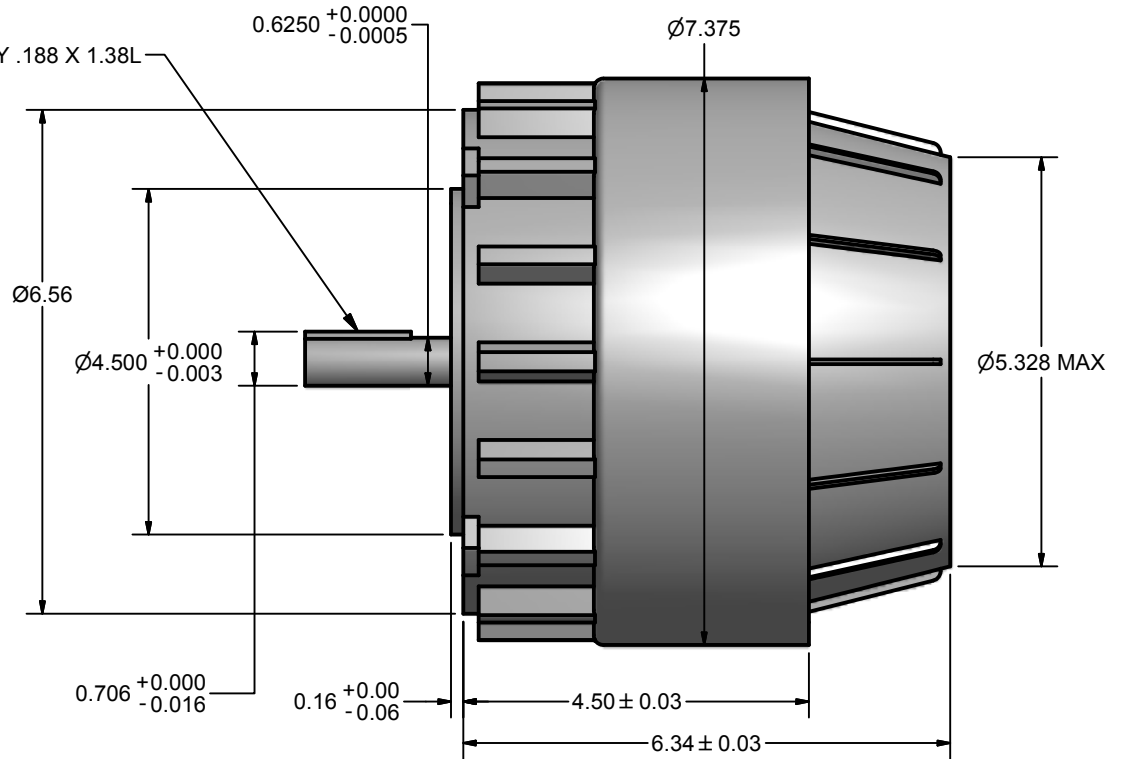

AM STD KEY .188 X 1.38L

PERFORMANCE SPECS	UNITS
Peak Torque	326 lbs-in
Rated Speed	3000 RPM
Rated Continuous Torque @ 25 C	29 lbs-in
Rated Power Output	1036 Watts
Continuous Stall Torque	31 lbs-in
Cogging Torque	0.0 lbs-in
Rated Terminal Voltage	127.0 Volts
Rated Continuous Current	9.5 Amps
Peak Current	100 Amps
Continuous Stall Current	9.6 Amps
Back EMF Constant +/- 10%	39.0 V/kRPM
Moment of Inertia	0.084 oz-in-sec ²
Torque Constant +/- 10%	52.8 oz-in/Amp
Weight	17.5 lbs

TACHOMETER	
PARAMETERS	UNITS
Emf/1000 RPM open circuit	3+5%-0%
Max speed	4000 RPM
Weight	2.2 lbs

DRAWN Sal	3/4/2011	UNLESS OTHERWISE SPECIFIED 1. DIMENSIONS ARE IN INCHES 2. TOLERANCES: ANGLES +/- 0.30 3. PLACE DEC +/- .005 4. PLACE DEC +/- .010 5. SURFACE ROUGHNESS ON MACHINED SURFACES: REMOVE ALL BURRS, BREAK SHARP EDGES TO .015 IN. MAX 6. DIM. LIMITS ARE HELD AFTER PLATING 7. MACHINED DIAS. ON A COMMON CENTER 8. LINE CONCENTRIC WITHIN .005 T.I.R. 9. UNMACHINED DIAS. CONCENTRIC WITHIN .031 T.I.R. 10. SQUARENESS AND PARALLELISM OF MACHINED SURFACES .002 PER INCH TO A MAX OF .012 FOR A SINGLE SURFACE.	TITLE 16CD-16CDT		
MFG			PART NO 16CD-16CDT	JOB NO	REV
APPROVED		SCALE SHEET 1 OF 1			